

FOR SALE - Close in SE Industrial Warehouse Space

\$3,900,000.00

110 SE Main Street Portland, Oregon 97214



Commercial Black LLC
John Gibson
Licensed Oregon Principal Broker
OR #971000078
623 NE 23rd Avenue
Portland, Oregon 97232
Direct 503.234.0820
Mobile 503.860.3267
john.gibson@commercialblack.com



Maximizing Value with Market Knowledge

FLOOR PLAN

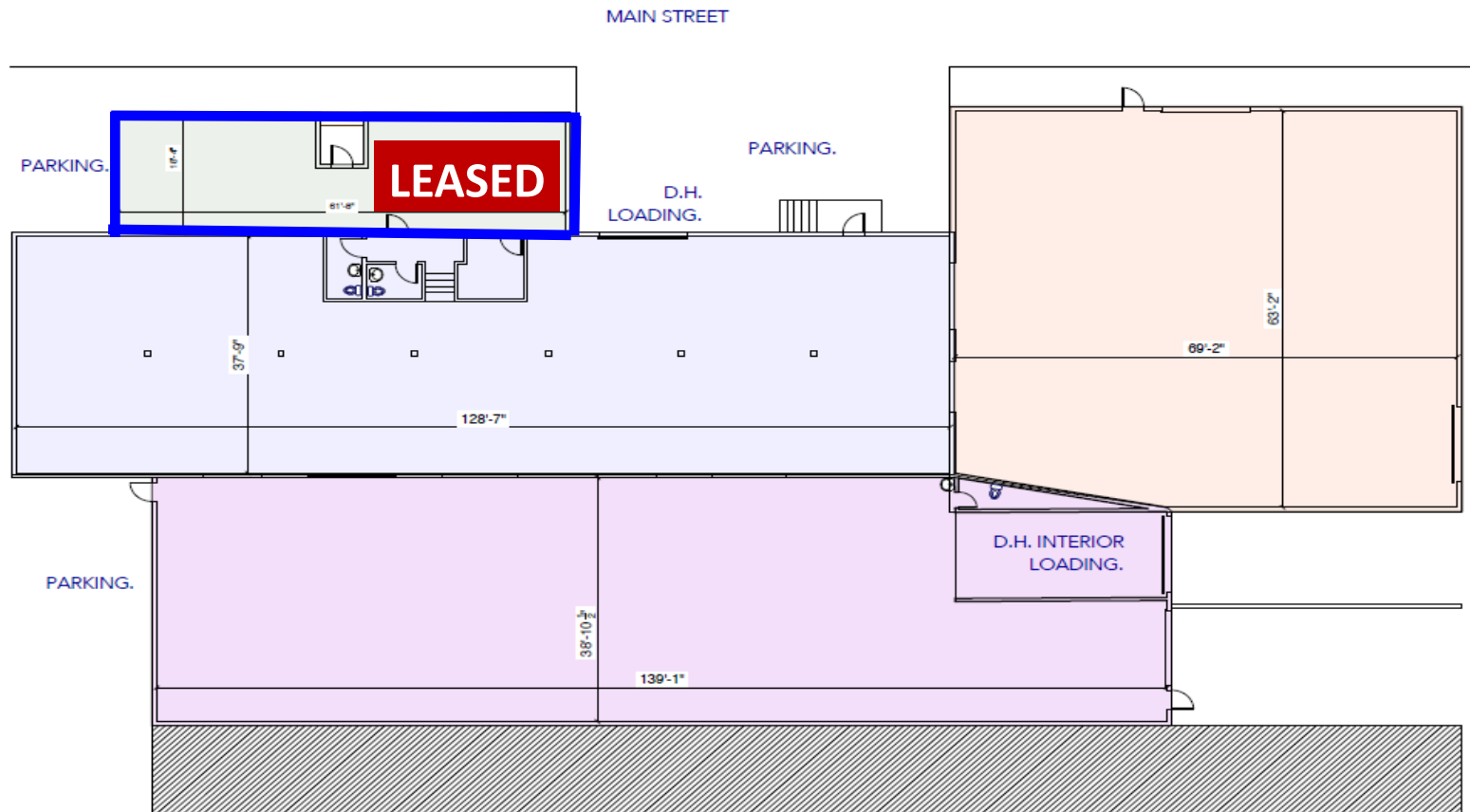

01. As Built Floor Plan

0 4' 8' 16'
 ORIGINAL SCALE: 1/8" = 1'-0"



NOT FOR CONSTRUCTION

SECOND AVENUE

135 SE Main Street Warehouse
 PORTLAND, OR

ISSUES & REVISIONS		
NO.	DATE	DESCRIPTION

ISSUED: November 21, 2017

As-Built

AB1

SHEET TOTAL: 1 OF 1 SHEETS

110 SE Main Street Portland, Oregon 97214



General Information

Year Built	1939
Site Area (2 tax lots)	+/- 20,000 SF
Zoning	IG1

Space

Total Warehouse SF	+/- 16,487
Loading	(2) Dock & (3) Grade
Clear Heights	+/- 14 feet

Sale Terms

Available:	+/- 15,266 SF
Leased:	+/- 1,221 SF
Sale Price	\$3,900,000
Seller Financing	for Qualified Buyer

